

- ▶ ROLLY_EGO
- ▶ 60.002.108

WARNINGS

In this sheet are included important informations regarding the conditions of use and safety of installation. Respect this instructions and keep them for eventual following consultations. The module **ROLLY-EGO/60.002.108** is suitable to control of an asynchronous single-phase motor powered by supply for movements of awnings, roller shutter or similar, any other use is inappropriate and prohibited.

1. TECHNICAL DATA (in reference of 20°C temperature)

- Power Supply: 120 or 230 Vac, 50/60 Hz
- Contacts Capacity: 5A x 250 Vac
- Dimensions: 45 x 33 x 25 mm
- Weight: 40 g
- Working Temperature: from -20 to +55 °C
- Degree of protection: IP20
- Time of work: 130 sec
- Radio Frequency: 433.92 MHz
- Memorizable Transmitter: 15 (include radio sensor)
- Capacity (estimate): 100 m in open field, 20 m inside buildings

2. NOTES ABOUT RADIO SYSTEMS

- Radio installation cannot be used where there is a high disturbing factor (for examples: near police stations, airports, banks and hospitals). However it is advisable that a technician could see the place before installing any kind of radio system in order to verify the possibility of a radio installation.
- Radio devices can be used only if any possible interferences or malfunction of the transmitter or of the receiver are not a factor of risk, or if the factor of risk is cancelled by security system.
- Radio installations working in the same frequency field can disturb one another causing a no correct working of the radio system.

3. ELECTRIC CONNECTIONS

- The module has to be installed from technical qualify staff to respect all the rules and laws in forces on the territory.
- The module is subject by dangerous electric voltage.
- Make connections without supply.
- Work with caution on the module, use suitable tools.
- Verify that the line of supply doesn't result from circuit for lighting.
- The line of supply has to be protected by a suitable magnetothermic or differential device.
- In case of many radio installations in the same system, the distance between them doesn't have to be less than 1,5 mt.
- Do not install the module near metallic surface.
- Do not modify or replace parts without authorization of the head office.
- Connect the motor with ground wire.
- Adjust the limit switch of the motor before connect it to the module.
- Is forbidden and dangerous open or tamper the case.
- The aerial cable is subject by supply voltage. Is forbidden and dangerous cut off the aerial cable.
- The module **ROLLY-EGO/60.002.108** hasn't any protection for water and only one essential protection for the contact with hard parts. Is forbidden install the control unit in places not protected.
- The module **ROLLY-EGO/60.002.108** hasn't any protection against overloaded or short circuit on the ways out. For that reason is necessary protect loaded, for example avail a fuse for 3.15 A.

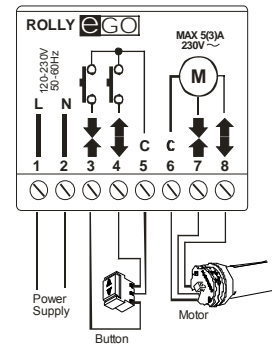

3.1 Supply

The module **ROLLY-EGO/60.002.108** can be supply with voltage of 120 Vac or 230 Vac and frequency 50/60 Hz. The supply can be practice on the terminals 1 and 2

3.2 Connection with motor

The motor wrappings have to be connected with terminal 7 and 8, the common wire of the motor has to be linked with terminal 6. Is forbidden connect more than one motor directly to the control unit. In case of been necessary command more motors with one central unit, avail appropriate expansion schedule.

3.3 Connection with buttons

The control buttons have to be connected with terminals 3 and 4, the common wire of the buttons have to be linked to terminal 5. The control buttons have to be in **momentary position**, do not avail any switches with keep position. Many control buttons can be connected to the control unit through a parallel connection. For apply an up or down order press the relative key at least 0,5 sec, for stop the manoeuvre press briefly anyone of the control buttons. The control buttons are subject with supply and therefore they must have to be suitable isolated and protected.

4) COMPATIBLE TRANSMITTERS

4.1 Portable transmitters

The module **ROLLY-EGO/60.002.108** is compatible with all transmitters series **OTELLO/60.003.001** and **VECTOR/60.003.011** and it can hold since 15 different radio codes in its memory, one of them could be the code of the radio sensor **ECLIPSE RADIO/60.001.115** or equivalent. The memorization of the portable transmitters happens as describe at point 6.1.

4.2 Radio Sensor ECLIPSE RADIO/60.001.115 (or equivalent)

The module **ROLLY-EGO/60.002.108** can manage a radio sensor model **ECLIPSE RADIO/60.001.115** or equivalent. The operation threshold of wind and sun can be directly program on radio sensor. If the system is install correctly, the wind alert operation (the most important of any other command) controls a manoeuvre of upward and inhibits any other order since the condition of wind alert is on. For more detail informations see the instruction of sensor **ECLIPSE RADIO/60.001.115**.

4.2.1 Manoeuvre regarding wind sensor

If the wind intensity exceeds the threshold post on the radio sensor, it orders a manoeuvre of upward to the module and inhibits any other commands since the condition of wind alert is on.

4.2.2 Manoeuvre regarding sun sensor

If the sun intensity overtakes at least 2,5 minutes the sun threshold post on radio sensor, it orders a manoeuvre of downward to the module; if the sun's intensity overtakes at least 18 minutes under threshold post on radio sensor, it orders a manoeuvre of upward to the module.

4.2.3 Activation/deactivation of sun function

If you would that the module manage only the informations sending by radio sensor regarding the sun speed, deactivate the sun function on portable transmitter; if you would that the central unit manage even the informations sending by radio sensor regarding the intensity of the sun, activate the sun function on portable transmitter. The activation/deactivation metode of the sun sensor is describe on the instructions manual of the transmitter at point "sun function".

4.3 General Radio Sensor

The module **ROLLY-EGO/60.002.108** can manage other types of radio sensor products by the same head office. The storage of radio sensor can be done as any other usual transmitter (see point 6.1). Where provided, the operation threshold can be program directly on radio sensor. For more detail informations see the instruction of radio sensor.

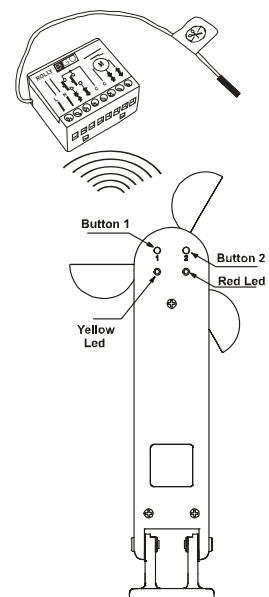

5) FIRST INSTALLATION

Just is powered, the module verify to have at least one transmitter of series **OTELLO/60.003.001** or **VECTOR/60.003.011** in its memory. If only one transmitter is in memory, the module begins its usual activity, instead the memory is empty, the module orders **4 little movements** of the motor and begins in "transmitter programmation", waiting a valid code by a portable transmitter. To insert the first transmitter in memory:

- if the 4 movements of the motor were been in **upward** position, press the button "UP" of the transmitter to insert in memory.
 - if the 4 movements of the motor were been in **downward** position, press the button "DOWN" of the transmitter to insert in memory.
- If after 8 sec from the stop of 4 little movements, it hasn't receipt the valid radio order of UPWARD or DOWNWARD yet, the module exits from the programmation and the motor will be operate only with button of command.

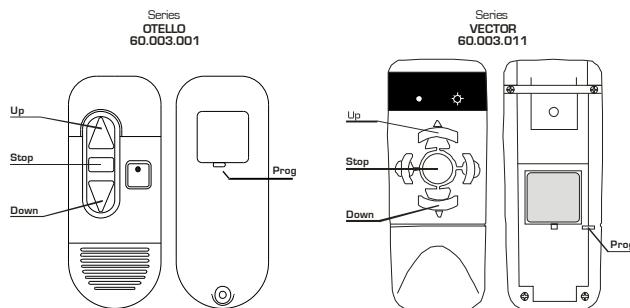

6) PROGRAMMATIONS FROM TRANSMITTER

Through any portable transmitter previously memorized can be effect some operation regarding memorization and cancellation of transmitter and setting out of the "radio test" function.

6.1 Insert in memory of a new one transmitter

- Carry the motor in intermediate position, so that be visible the movements of report of the motor.
- Press **PROG** for about 4 sec of a portable transmitter previously memorized, since the motor effects 2 movements in upward position to signal the entry in "transmitters programming".
- Within 8 sec, press **UP** or **STOP** or **DOWN** button of the transmitter to be memorized (in case of radio sensor press the key indicated in its instruction).
- The central unit memorizes the code and advice with a movement of the motor in upward position.

6.2 Memory cancellation of a transmitter

- Carry the motor in intermediate position, so that be visible the movements of report of the motor.
- Press **PROG** of a manual transmitter previously memorized for about 4 sec, since the motor effects 2 upward movement to advice the entry in "transmitter programming".
- Within 8 sec, press **UP** or **STOP** or **DOWN** button of the transmitter which is going to be cancelled (in case of radio sensor press the key indicated in its instruction).
- The central unit memorizes the code and advice with a movement of the motor in downward position.

6.3 Radio test

As soon as the central unit **ROLLY-EGO/60.002.108** is memorized, one radio sensor **ECLIPSE RADIO/60.001.115**, is automatically activate a communication test between radio sensor and central unit. If this communication between radio sensor and central unit could be absent (for failure of one or both systems or for interferences by other systems or for other factores), the central unit orders an upward manoeuvre. This manoeuvre is periodically keep (about every 20 min) since when the radio communication results restored. To modify the formulation of radio test:

- Carry the motor in intermediate position, so that be visible the movements of report of the motor.
- Press **PROG** of one manual transmitter previously memorized for about 4 sec, since the motor effects 2 upward movement to advice the entry in "transmitter programming".
- Shortly press **PROG**. If the motor moves upward, the "radio test" is able, if the motor moves downward the "radio test" is disabled.
- If the "radio test" setting is the right desired, adverting without command any operation. After about 8 sec the motor stops and the central unit goes out of the programming, and goes on with its normal working.
- If you would change the "radio test" impostation, press **UP** or **STOP** or **DOWN** of the transmitter. The central unit will modify the "radio test" setting and moves the motor in upward position if the radio test is able, or downward if the test radio is disabled.

7) RESTORE OF THE FACTORY CONDITIONS (reset)

- Take off voltage on the module.
- Connect the button terminals like in the picture.
- Power the module. After about 30 sec the motor effects two short movements (one opposite to the other) to signalize the restore of the factory's conditions.
- Take off voltage to the central unit.
- Restorage the connections.
- Power the module. Follow the indications in section 5 ("First installation").

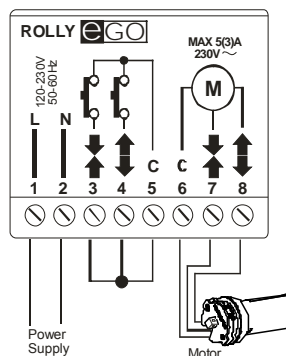

8) EXPIRED



At the end of the cycle of the product, dispose as provided by local regulation. This product can be contain polluting substance for the environment and dangerous for health, is forbidden dispose the product with the domestic waste.

9) FAQ AND PROBLEM SOLUTION

? **Just powered the central unit, the motor must effect 4 movements in upward or downward position, but it didn't happened.**

- Verify the presence of supply in terminals **1** and **2**.
- Verify the electric connections.
- Effect the reset of the system (see point 7).

? **Can't memorize the first transmitter.**

- Make sure of correctly keep the setting of first installation (see point 5).
- Verify that the batteries of the transmitter are loaded.
- Try to effect the same operation with another transmitter.
- Verify that environment doesn't be disturbed by other devices working in the same frequency (radioearphones, alarms, ecc).
- Effect a reset of the system (see point 7) and try another insert of the transmitter.

? **When try to memorize another transmitter, the motor effects 2 movements downward.**

- Make sure of correctly keep the memorization setting (point 6.1).
- The operation could be perform rather slow. When the central unit is on "transmitter programming" you have a range of time of 8 sec to press UP or STOP or DOWN button of the trasmitter that will be memorize.
- Verify that the batteries of the transmitter are load.

? **When try to memorize a transmitter, the motor effects 1 upward movement and 3 downward movements.**

- The central unit advices that it has memorize yet the top numbers of 15 allow trasmitters.

? **When we try to cancel a transmitter in the memory, the motor effects 2 downward movements.**

- Make sure of correctly cancel (see point 6.2).
- The operation had been done rather slowly. When the module begins in "transmitter programming" you have a range of time of 8 sec to press UP or STOP or DOWN of the transmitter that you have to cancel.
- If the module has in its memory only one portable transmitter, this operation is forbidden.

? **The module has in its memory a sensor ECLIPSE RADIO/60.001.125 but in presence of wind the motor doesn't work in upward.**

- Make sure that the radio sensor had been correctly memorized.
- The wind threshold set up on radio sensor could be more high.

- The radio sensor could be rather expose from the wind.
 - The radio sensor could be too far away from the receiver, or the capacity could be limited by obstructiones.
 - Radio connection could be disturbed by devices working in the same frequency.
 - Check the working of wind sensor (see istruction of **ECLIPSE RADIO/60.001.115**).
- ? The central unit has in its memory a sensor ECLIPSE RADIO/60.001.115, in presence of wind the motor effects upward movement, but in presence of sun doesn't work in downward.**
- The sun threshold set up on radio sensor could be more high.
 - Radio sensor could be installed in rather exposition from the sun, or some obstructiones could prevent the correct sun survey.
 - The function sun could be inactive (see point 4.2.3).
 - Check the working of sun sensor (see istructions of **ECLIPSE RADIO/60.001.115**).

-
- All the products and the specific techicals contained in this document are subjected to variations without any warning.
 - Only in case of concessions and specific case preaviously agreement with the head office the device has to be used only with received device from the same head office.
 - The manufacturer can not be considered responsible for eventual damage caused by inappropriate, wrong or unreasonable use.
 - MASTER declares that the device is accordance with the principal requirement and the other arrangement provided by directive 1999/5/CE. The declaration of conformity is available in this site <http://www.masterautomation.it/certificazioni/pagine>.

